

COMPONENTS: (RESIDENTIAL)

#158 DIXIE	6063-T52 ALUM.	TOP CAP
1-1/2" x 3/4" x 1/8"	6061-T6 ALUM	RAIL (TOP)
1-3/4" x 1-3/4" x 1/8"	6061-T6 ALUM.	POST TAPERED
1/2" x 1/2" x 1/8"	6061-T6 ALUM.	PICKET
1-1/2" x 1" x 1/8"	6061-T6 ALUM	RAIL (BOTTOM)

COMPONENTS:

#158 DIXIE	6063-T52 ALUM.	TOP CAP
1-1/2" x 3/4" x 1/8"	6061-T6 ALUM	RAIL (TOP)
1-3/4" x 1-3/4" x 1/8"	6061-T6 ALUM.	POST TAPERED
3/4" x 3/4" x 1/8"	6061-T6 ALUM.	PICKET
1-1/2" x 1" x 1/8"	6061-T6 ALUM	RAIL (BOTTOM)

ALTERNATE COMPONENTS:

1/2" x 1/2" TWIST	6061-T6 ALUM. BAR	PICKET
-------------------	-------------------	--------

ALTERNATE COMPONENTS:

3/4" x 3/4" TWIST	6061-T6 ALUM. BAR	PICKET
-------------------	-------------------	--------

COMPONENT DETAILS (REIDENTIAL)

SCALE: 6"=1'-0"

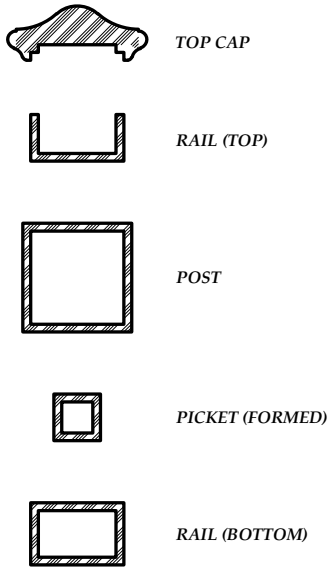

COMPONENT DETAILS

SCALE: 6"=1'-0"

NOTE:
THIS SERIES IS AVAILABLE FOR BOTH RESIDENTIAL APPLICATIONS AT 36" AND COMMERCIAL APPLICATIONS AT 42" HIGH

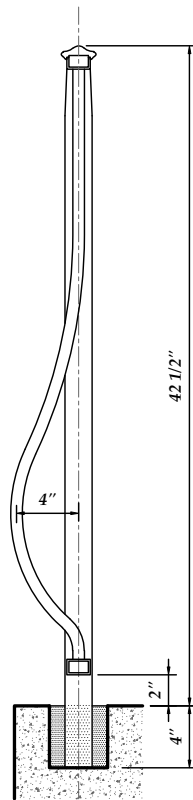

2
13 GUARDRAIL SECTION
SCALE: 1-1/2"=1'-0"

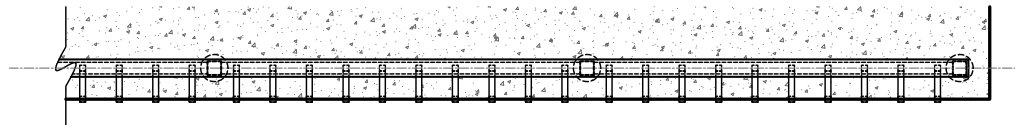

1
13 PLAN VIEW
SCALE: 3/4"=1'-0"

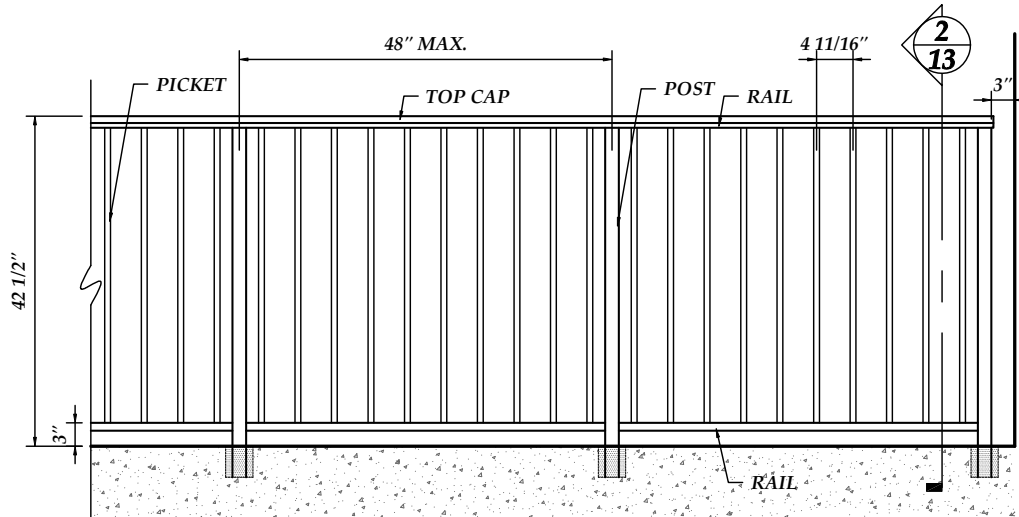

1
13 GUARDRAIL ELEVATION
SCALE: 3/4"=1'-0"

Color:	MULLETS ALUMINUM
Revision:	VRS-400
Page:	13
Customer:	MULLETS ALUMINUM
Project Name:	VRS-400
Date:	December 10, 2010
Drawn By:	JRB
Scale:	AS NOTED
Drawing Description:	TYPICAL DETAILS
<p>MULLETS' ALUMINUM PRODUCTS INC. WELDING FABRICATION DEPT. 905 Ponder Ave. Office # (941) 371-3502 Sarasota, FL 34232 Fax # (941) 378-5676</p>	