

POST CAP

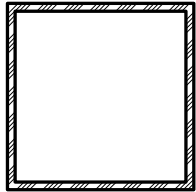

TOP CAP



POST

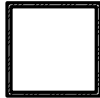

PICKET

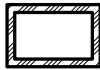

RAIL

**COMPONENT DETAILS**  
SCALE: 6"=1'-0"

**NOTE:**  
THIS SERIES IS AVAILABLE FOR BOTH  
RESIDENTIAL APPLICATIONS AT 36" AND  
COMMERCIAL APPLICATIONS AT 42" HIGH

**COMPONENTS:**

4" x 4" x 3/4"	6061-T6 ALUM.	POST CAP
#133 TYPE	6063-T52 ALUM.	TOP CAP
3" x 3" x 1/8"	6061-T6 ALUM.	POST
1-1/2" x 1-1/2" x 1/16"	6061-T6 ALUM.	PICKET
1" x 1-1/2" x 1/18"	6061-T6 ALUM.	RAIL

**ALTERNATE COMPONENTS:**

2-1/2" x 2-1/2" x 1/8"	6061-T6 ALUM.	POST
1" x 1" x 1/16"	6061-T6 ALUM.	PICKET

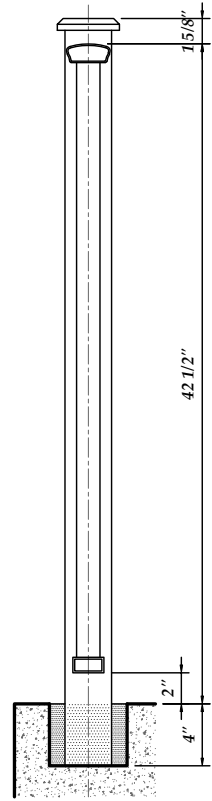

**2**  
**12** **GUARDRAIL SECTION**  
SCALE: 1-1/2"=1'-0"

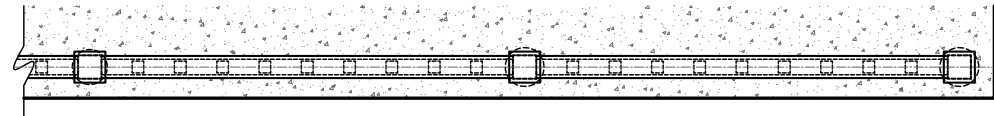

**1**  
**12** **PLAN VIEW**  
SCALE: 3/4"=1'-0"

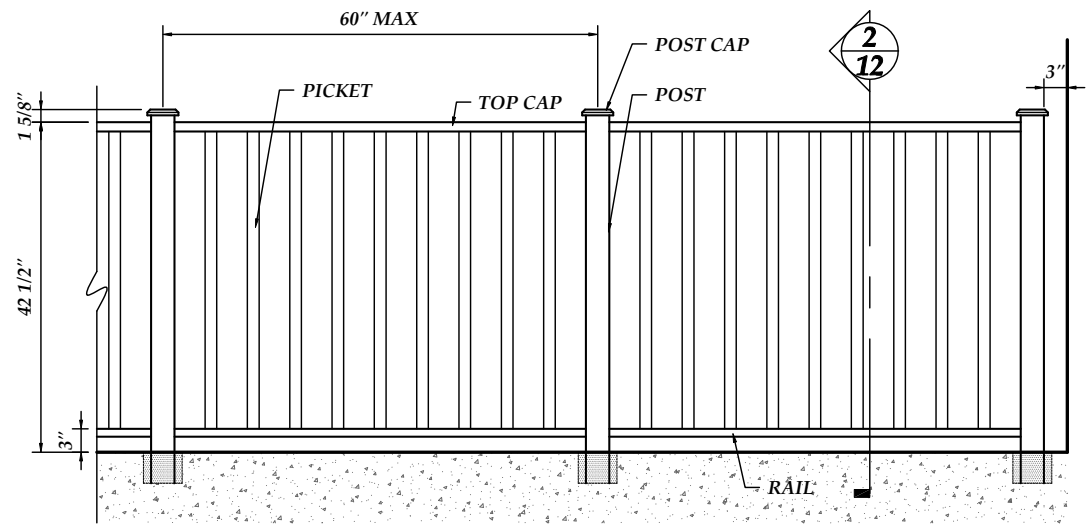

**1**  
**12** **GUARDRAIL ELEVATION**  
SCALE: 3/4"=1'-0"

Color:	MULLETS ALUMINUM
Revision:	VRS-300
Page:	12
Customer:	MULLETS ALUMINUM
Date:	December 10, 2010
Project Name:	VRS-300
Drawing By:	JRB
Drawing Description:	TYPICAL DETAILS
Scale:	AS NOTED
<p><b>MULLETS ALUMINUM PRODUCTS INC.</b> WELDING FABRICATION DEPT. 905 Ponder Ave. Office # (941) 371-3502 Sarasota, FL 34232 Fax # (941) 378-5676</p>	